



Mount Rise, Halstead, Essex, CO9 1ES

Rent - £1,250 PCM Deposit - £1,442

Scott Maddison are pleased to offer for rent this three bedroom mid-terrace house, which comprises of entrance hall, cloakroom, eat-in kitchen, lounge/dining room, and first floor bathroom. The property also benefits from front and rear gardens together with a single garage situated in a block opposite.

- MID TERRACE HOUSE
- THREE BEDROOMS
- LOUNGE/ DINING ROOM
- CLOAKROOM AND FAMILY BATHROOM
- FRONT AND REAR GARDENS AND SINGLE GARAGE IN BLOCK
- EAT-IN KITCHEN
- GAS HEATING AND EPC RATING C
- APPROXIMATE SIZE - 839 SQ FT
- SORRY NO PETS/ COUNCIL TAX BAND C
- AVAILABLE FEBRUARY



Council Tax Band: C - EPC Rating: C 73

GROUND FLOOR
39.2 sq.m. (422 sq.ft.) approx.

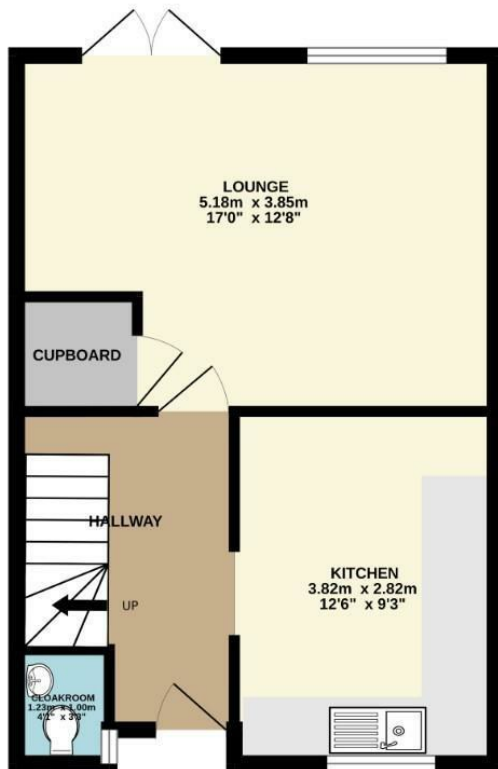

1ST FLOOR
39.0 sq.m. (419 sq.ft.) approx.

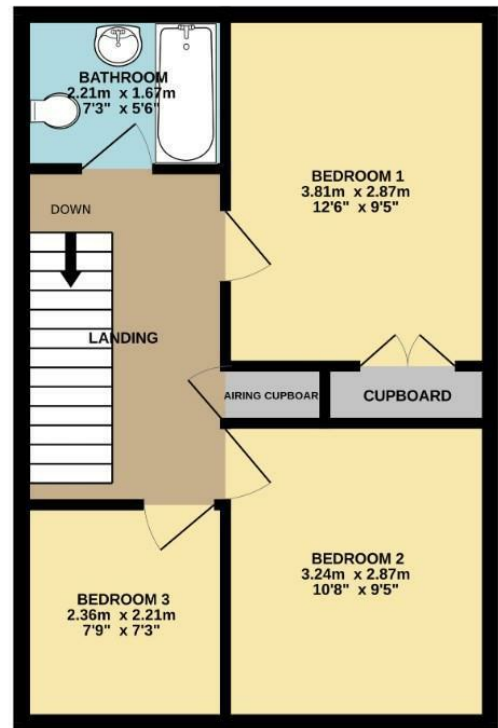

TOTAL FLOOR AREA: 78.2 sq.m. (842 sq.ft.) approx.

Whilst every attempt has been made to ensure the accuracy of the floorplan contained here, measurements of doors, windows, rooms and any other items are approximate and no responsibility is taken for any error, omission or mis-statement. This plan is for illustrative purposes only and should be used as such by any prospective purchaser. The services, systems and appliances shown have not been tested and no guarantee as to their operability or efficiency can be given.

Made with Metropix ©2025

